

TYPE A: In Line

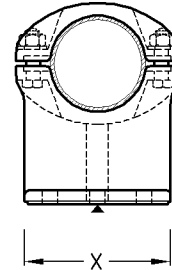

TYPE B: Offset

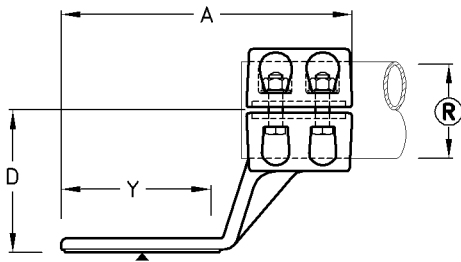
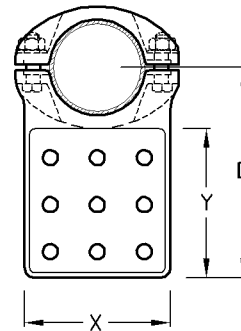
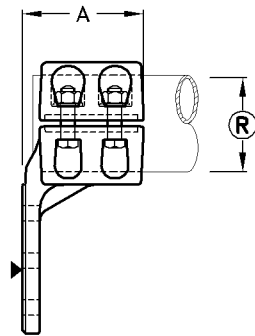

TYPE C: 90°

TBP-Type Palm Terminal Clamp

Type No.	Catalogue No.	Tube Dia. Ⓜ	Palm Size		A	D	Max Rating Amps	Unit Weight
			X	y				
TBP-80/125P/A	C24253	80	125	125	225	N/A	2300	2.20kg
TBP-80/120/125P/B	C24283	80	125	125	235	120	2300	2.60kg
TBP-80/125P/90/C	C24293	80	125	125	105	178	2300	2.40kg
TBP-100/125P/A	C25203	100	125	125	225	N/A	2800	2.40kg
TBP-100/120/125P/B	C25223	100	125	125	235	120	2800	2.90kg
TBP-100/125P/90/C	C25233	100	125	125	105	188	2800	3.10kg
TBP-120/125P/A	C26203	120	125	125	230	N/A	3300	3.30kg
TBP-120/150/125P/B	C26233	120	125	125	240	150	3300	3.30kg
TBP-120/125P/C	C26243	120	125	125	115	200	3300	3.10kg

- Note:**
- 1) Palm and busbar contact surface areas are serrated.
 - 2) Palms are drilled to IEC 518 : 9 Dia. 14 Holes at 40mm centres.
 - 3) Material: Cast Aluminium
: Bolts & Nuts are Steel HT.8.8. H.D.G. (Other materials and grades available on request)
 - 4) Voltage: 500kV Max.