

### TBEC/P-Type Plain End Cap

Type No.	Catalogue No	Tube Dia. ⊙	Securing Bolts A	Unit Weight
TBEC/P-80	C17042	80	2 X M6	0.26kg
TBEC/P-100	C25813	100	3 X M6	0.45kg
TBEC/P-120	C17223	120	3 X M6	0.62kg
TBEC/P-150	C17323	150	3 X M6	6.70kg
TBEC/P-160	C28483	160	3 X M6	0.75kg
TBEC/P-200	C17423	200	3 X M6	2.10kg
TBEC/P-250	C17523	250	3 X M6	2.70kg

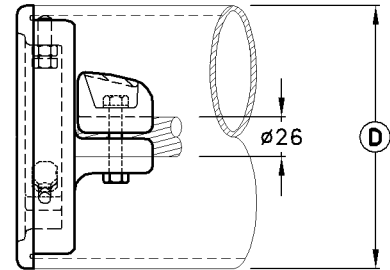
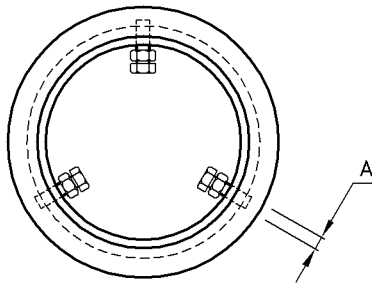

### TBEC/C-Type Vibration Damper/Conductor Fixing End Cap

Type No.	Catalogue No	Tube Dia. ⊙	Securing Bolts A	Unit Weight
TBEC/C-80	C17053	80	2 X M6	0.46kg
TBEC/C-100	C25823	100	3 X M6	0.55kg
TBEC/C-120	C17243	120	3 X M6	0.62kg
TBEC/C-150	C17333	150	3 X M6	0.70kg
TBEC/C-160	C28473	160	3 X M6	0.95kg
TBEC/C-200	C17443	200	3 X M6	2.70kg
TBEC/C-250	C17543	250	3 X M6	3.10kg

- Note:**
- 1) End caps are machined to suit specified tube wall thicknesses.
  - 2) Tube wall thickness to be specified when ordering.
  - 3) End caps may be supplied colour coded to IEC specification on request only.
  - 4) Material: Cast Aluminium  
: Bolts & Nuts are St.Steel. (Other materials and grades available on request)
  - 5) Voltage: 500kV Max.