

Non-Tension Compression Lug Bi-Metal Medium Voltage

Catalogue No.	Cond. T	Dia./Colour Code	A	Stud Size B	C	Approx. Weight
	Name					
L305113	Squirrel/Acacia Magpie/35mm ² Fox/Fir	4.5–9.0 Blue/Green /Orange	75	M12	5	0.140kg
L305023	Squirrel/Acacia Magpie/35mm ² Fox/Fir	4.5–9.0 Blue/Green /Orange	75	M16	5	0.145kg
L305313	Hare/Oak Mink/Pine	9.0–15.0 Red/Brown	100	M12	6	0.195kg
L305223	Hare/Oak Mink/Pine	9.0–15.0 Red/Brown	100	M16	6	0.200kg

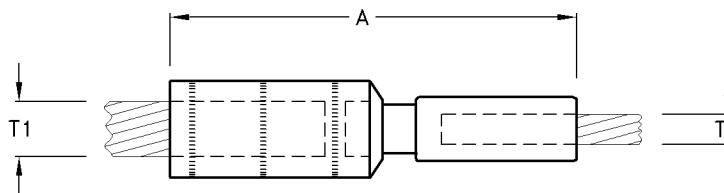

Non-Tension Compression Joint Bi-Metal Medium Voltage

Catalogue No.	Cond. T1(Alu)	Dia./Colour Code	Cond. T2 (Cu)	Dia.	A	Approx. Weight
	Name					
L205253	Squirrel/Acacia Magpie/35mm ² Fox/Fir	4.5–9.0 Blue/Green /Orange	25mm ²	6.4	102	0.130kg
L205263	Mink/Pine	7.0–12.0 /Red	50/95mm ²	9.5–12.8	125	0.140kg
L205373	Hare/Oak	9.0–15.0 /Brown	120mm ²	14.4	125	0.155kg

- Note:**
- 1) Use Bimetal 4E-4 Way Indent Crimper.
 - 2) Compression tubes are marked showing conductor range/size and crimp positions.
 - 3) Other conductor sizes and combinations are available on request.
 - 4) Material: Annealed Copper/Aluminium friction welded.