

Socket Clevis Pin Type

Type No.	Catalogue No.	I.E.C. Socket	A	B	U.T.S (kN)	Unit Weight
SC-70	B30403	16B	65	19	70	1.00kg

- Note:** 1) Material: Malleable Cast Iron H.D.G.
: Clevis Pin D.F.Steel H.D.G.
- 2) Can be supplied either with split cotter pin or hump back split pin.
To be specified.

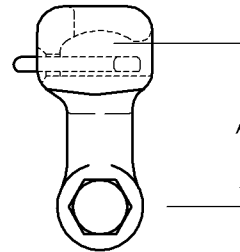
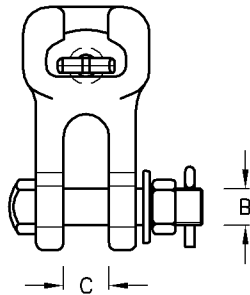

Socket Clevis Bolt Type

Type No.	Catalogue No.	I.E.C. Socket	A	B	C	U.T.S (kN)	Unit Weight
SC-120	H30453	16B	72	M16	19	120	1.00kg
SC-210	H300223	20	75	M20	21.5	210	1.20kg

- Note:** 1) Material: D.F.Steel H.D.G.
: Bolt H.T.Steel 8.8 H.D.G.
- 2) Can be supplied either with split cotter pin or hump back split pin.
To be specified.