

Y-Clevis/Ball Pin Type

Type No.	Catalogue No.	I.E.C. Ball	A	B	U.T.S (kN)	Unit Weight
YCB-70	B30343	16B	70	16	70	0.50kg

- Note:** 1) Material: D.F.Steel H.D.G.
 2) Can be supplied either with split cotter pin or hump back split pin.
 To be specified.

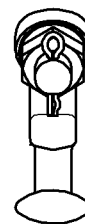
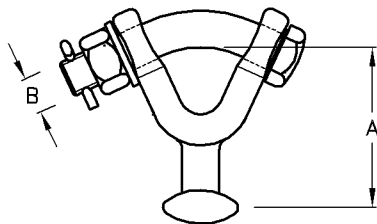

Y-Clevis/Ball Bolt Type

Type No.	Catalogue No.	I.E.C. Ball	A	B	U.T.S (kN)	Unit Weight
YCB-120	B30363	16B	70	M16	120	0.65kg

- Note:** 1) Material: D.F.Steel H.D.G.
 : Bolt H.T.Steel 8.8 H.D.G.
 2) Can be supplied either with split cotter pin or hump back split pin.
 To be specified.