

C1000

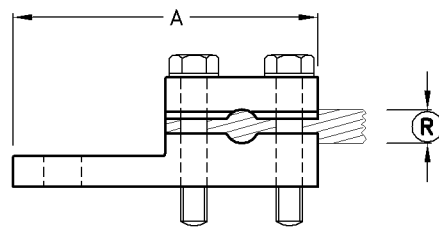

C1001/1002

Type No.	Catalogue No.	Conductor (R)		A	B	Amprage Rating	Unit Weight
		Min.	Max.				
C-1000	C29003	8	13	70	45	450	0.40kg
C-1001	C29013	7	13	80	40	450	0.50kg
C-1002	C29023	11	16	105	40	600	0.70kg

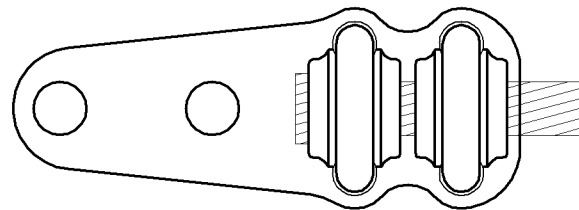
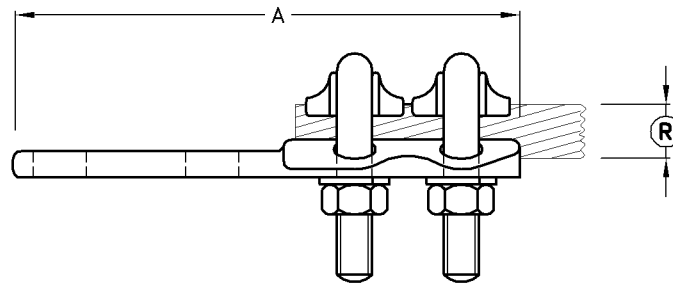

Terminal Lugs

Type No.	Catalogue No.	Conductor (R)		A	B	Amprage Rating	Unit Weight
		Min.	Max.				
C-1003	C29033	8	14	116	60	500	0.80kg
C-1004	C29043	12	20	116	60	800	1.00kg

- Note:**
- 1) Terminal lugs are cast to suit a range of conductor sizes.
 - 2) C1000/1/2 are fitted with cadmium plated bolts.
 - 3) C1000/1/2 are supplied drilled with Dia. 10 holes.
 - 4) C1003/4 are supplied drilled with Dia. 13 holes.
 - 5) Palms may be supplied undrilled or drilled to suit requirements.
 - 6) Material: GM3, hot tin dipped.
 - 7) Voltage : 150kV Max.