

## Parallel Grooved Clamp Current Carrying for Stranded Conductor

Type No.	Catalogue No.	Conductor Ⓜ	A	C	D	Max Rating Amps	No of Bolts	Unit Weight
PG 8-12/12-22	C22353	8/12-12/22	63	57	39	500	2	0.60kg
PG 18-20	C22213	18-20	95	80	40	600	2	0.80kg
PG 21-24	C22223	20-24	110	85	45	750	2	0.90kg
PG 25-29	C22233	25-29	130	105	55	900	3	1.60kg

- Note:**
- 1) Other conductor sizes are available on request.
  - 2) Material: Cast Aluminium  
: Bolts & Nuts-Steel HT.8.8 H.D.G.
  - 3) Voltage: 300kV Max.

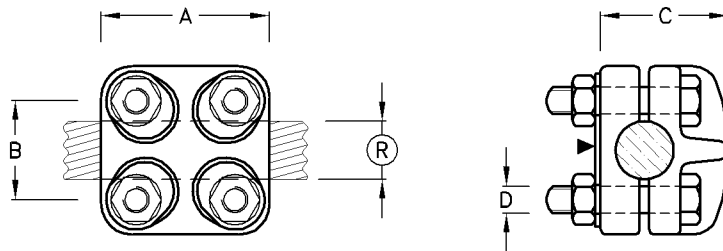

## ISOP 26-Type Terminal Palm Clamp

Type No.	Catalogue No.	Conductor Ⓜ	A	B	C	D	Max. Rating Amps	Unit Weight
ISOP 26	C22173	26.5	75	44	57	M12	900	0.70kg

- Note:**
- 1) Isop clamp can be cast to specified sizes up to  $\phi 26$
  - 2) Material: Cast Aluminium  
: Bolts & Nuts- Steel HT.8.8 H.D.G.
  - 3) Voltage: 300kV Max.